

CASTLEVIEW METROPOLITAN DISTRICT OVERALL BOUNDARY MAP

A PORTION OF SECTION 13, TOWNSHIP 8 SOUTH, RANGE 67 WEST AND A
PORTION OF SECTION 18, TOWNSHIP 8 SOUTH, RANGE 66 WEST
OF THE SIXTH PRINCIPAL MERIDIAN,
TOWN OF CASTLE ROCK, COUNTY OF DOUGLAS, STATE OF COLORADO

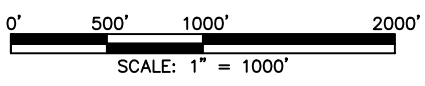
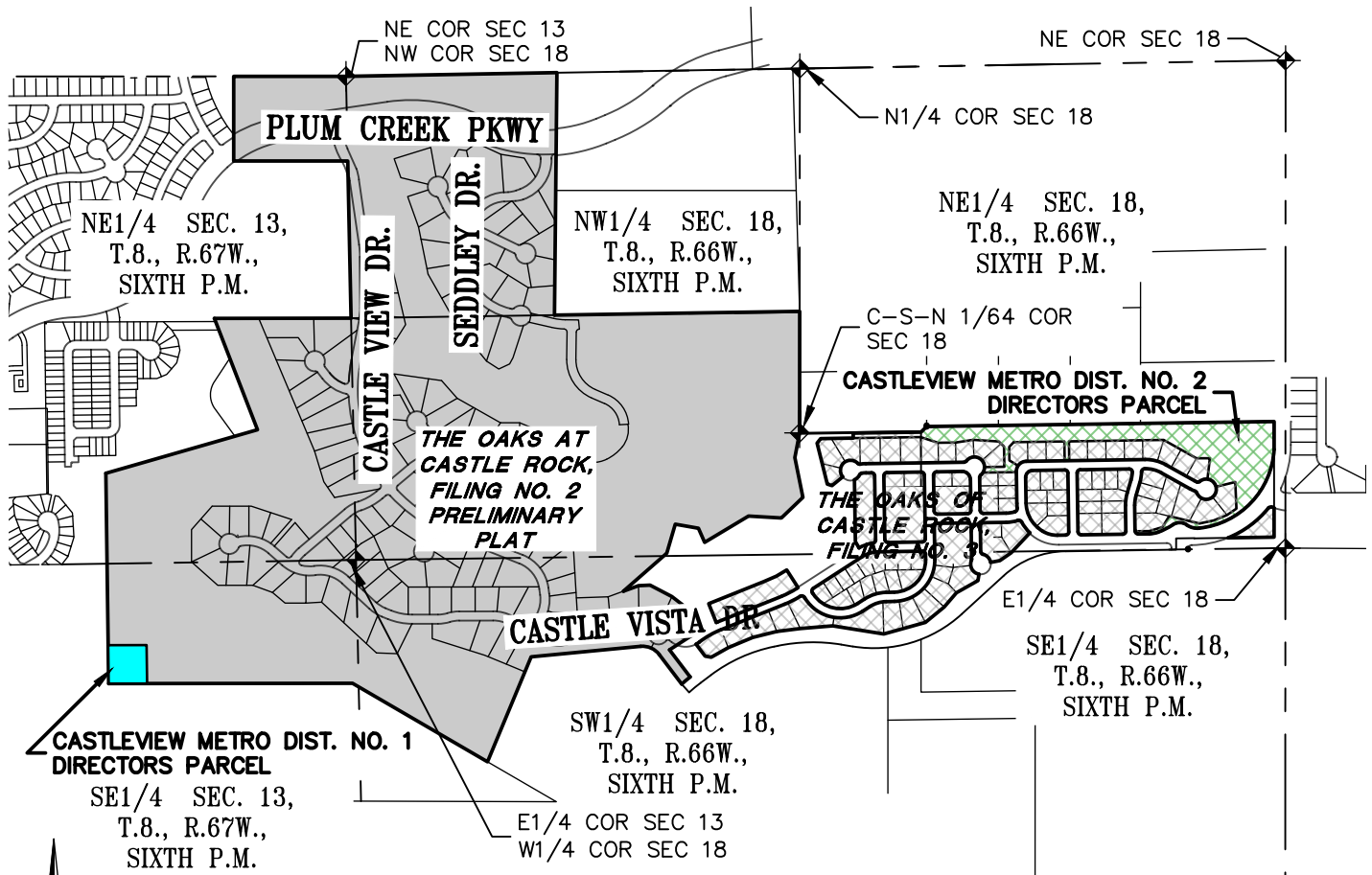

- CASTLEVIEW METROPOLITAN DISTRICT NO. 1
- CASTLEVIEW METROPOLITAN DISTRICT NO. 1 DIRECTORS PARCEL
- CASTLE VIEW METROPOLITAN DISTRICT NO. 2
- CASTLEVIEW METROPOLITAN DISTRICT NO. 2 DIRECTORS PARCEL

NOTE: THIS DRAWING DOES NOT REPRESENT A MONUMENTED LAND SURVEY AND IS ONLY INTENDED TO DEPICT THE ATTACHED LEGAL DESCRIPTION.

PATH: Q:\134118-01\DWG\EXHIBITS\
 DWG NAME: _____
 DWG: MDW CHK: DSB
 DATE: 10/1/2018
 SCALE: 1" = 1,000'

AZTEC
CONSULTANTS, INC.
 300 East Mineral Ave,
 Suite 1
 Littleton, Colorado 80122
 Phone: (303)713-1898
 Fax: (303)713-1897
www.aztecconsultants.com

OVERALL DISTRICT BOUNDARY MAP
 CASTLEVIEW METROPOLITAN DISTRICT
 DOUGLAS COUNTY, COLORADO
 JOB NUMBER 134118-01 1 OF 1 SHEETS